



SOPHIA UNIVERSITY

7-1 Kioi-cho, Chiyoda-ku, Tokyo, 102-8554 JAPAN

www.sophia.ac.jp/eng/

ACCESS

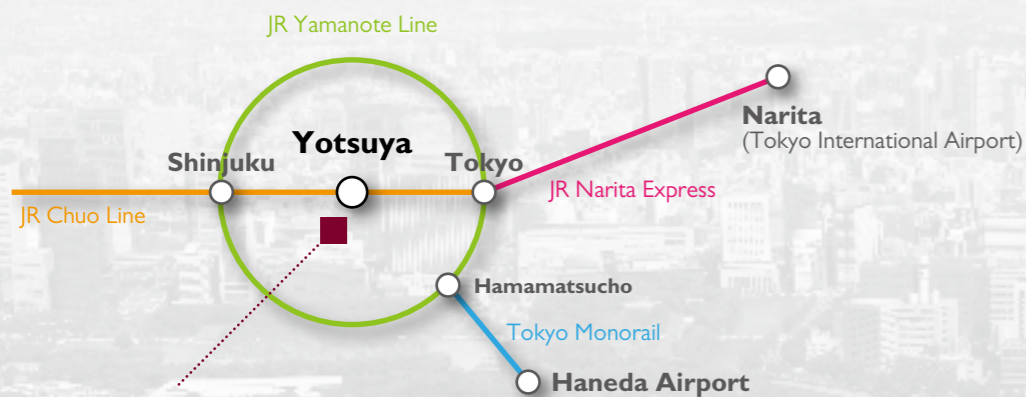

SOPHIA UNIVERSITY

is located in front of JR/Tokyo Metro Yotsuya Station.

CONTACT

Admissions
 International Relations & Exchange Programs
 Summer/January Sessions

Admissions Office
 Center for Global Education and Discovery
 Sophia Short-term Programs

Tel: +81-3-3238-4018
 Tel: +81-3-3238-3521
 Tel: +81-3-3238-4090

(2018.04)



SOPHIA UNIVERSITY

A Japanese University with a Global Mission

Sophia — Bringing the World Together



Tokyo Station

Imperial Palace

Houses of Parliament

SOPHIA UNIVERSITY

State Guesthouse

Yotsuya Station

Japan's Pioneer in Global Education

Sophia University leads the drive toward internationalization in Japan, providing innovative educational opportunities that take our increasingly complex world into account.

Over the years, Sophia University has developed a strong global network that attracts researchers and students from overseas to teach and study in Japan, and Japanese researchers and students to do the same abroad.

Sophia University provides an excellent educational environment in the era of internationalization, cultivating our mission "Men and Women for Others, with Others" so that we can excel on the global stage.

Message from the President

Greetings from Sophia University

As the 21st Century unfolds, we find ourselves in challenging times. Many barriers to equity have been removed, but not all. Our world seems to stand on a precipice, unsure of where it is heading. Many wonder, will countries become more divisive

or will we be able to rise above divisive beliefs and actions and become unified as one borderless global society.

Our university was founded on the belief that all people—no matter what one's religion, ethnicity, or nationality may be, should be brought together in peaceful unity and equity. This vision of our founding fathers holds strong today



at Sophia University, ensuring that we remain committed to their ideals and is reflected in our education principle 'Men and Women for Others, with Others.'

Higher education must constantly strive to enrich both the hearts and minds of students. How we instill dignity, respect and empathy in our students is a question we often ask ourselves at Sophia University. We encourage students to view the world from multiple perspectives, be critical thinkers and drivers of change towards a better future for all.

Dr. Yoshiaki Terumichi
President of Sophia University
Professor of the Faculty of Science and Technology

Facts & Figures

(As of 2017)

- * 9 undergraduate faculties with 29 departments
- * 10 graduate schools with 25 programs
- * Total Full-time Student Enrollment: 14,021
12,575 Undergraduate 1,369 Graduate 77 Law School
- * Number of International Students: 1,593
1,067 Undergraduate 526 Graduate
76 countries in total
- * Faculty Staff : 1,486
543 Full Time (22 countries) 943 Part Time
- * Administrative Staff: 381

The Origin of Sophia

The origin of Sophia University can be traced back over 460 years, to the visit to Japan by the Jesuit missionary St. Francis Xavier in 1549. In letters to Rome, St. Xavier wrote about his hopes to found a university in the Japanese capital. In 1913, charged with the mission of fulfilling St. Francis Xavier's vision, three Jesuits from Germany, the United Kingdom and France, Fr. Dahlmann, Fr. Rockliff and Fr. Boucher, established Sophia University in Tokyo.



Why choose Sophia ?

» One of the top private universities in Japan

Sophia's reputation for excellence in undergraduate education, outstanding graduate programs, and a competitive research environment enables it to maintain its ranking as one of Japan's top private universities. Students benefit immensely from the ability to study the latest developments in their chosen field of specialization with distinguished Japanese and international faculty members. Reflecting the quality of their education, Sophia graduates are highly regarded as leaders in the global workplace at multinational companies and international organizations.

» Japan's pioneer in global education

Sophia University has offered English-medium programs for more than 60 years. Reflecting the high regard in which its track record as a pioneer in global education is held, the University was chosen for a series of subsidy programs being implemented by the Ministry of Education, Culture, Sports, Science and Technology to internationalize universities in Japan, including the Global 30 Project and the Top Global University Project. These programs are helping to further strengthen the University's efforts to boost the global competency of our students. At the same time, agreements with 326 overseas universities in 69 countries ensure the dynamic mobility of our students. Over 1,500 international students are studying at Sophia from around the world, and are fostering an internationalized campus culture. The university is also renowned for encouraging Japanese students to study abroad with a broad spectrum of programs. Both incoming and outgoing students will discover how education really comes to life in an international context at Sophia.

» Diversity on one campus in the fascinating city of Tokyo

Sophia University has a compact footprint that brings together all faculties and graduate schools in the sciences and humanities on a single campus. This approach yields significant benefits for the University's programs by deepening educational mobility, collaboration, and specialization. By offering an environment that brings together students and faculty members from different cultural, linguistic, and religious backgrounds, the campus functions as a microcosm of global society. No less beneficial is the University's location in Tokyo, a megacity that invites students to enjoy all the benefits of its state-of-the-art technology, facilities, and infrastructure. Best of all, the city affords an invaluable opportunity to experience a unique culture in which traditional and modern elements intermingle.

» Wide variety of English-medium programs

Students can study business and economics, science and technology, and environmental studies, all strengths of Japan, in English. Sophia also boasts a long tradition in Japanese studies. *Monumenta Nipponica*, an English-medium scholarly journal that serves as an important resource for researchers studying Japan worldwide, is edited at the University. The following programs offer entirely of English-medium curriculum:

- Undergraduate level:* Liberal Arts, Science and Technology
- Graduate level:* Education, Global Studies, Global Environmental Studies, TESOL (Teaching English to Speakers of Other Languages), Science and Technology
- Non-Degree programs:* Liberal Arts, Center for Language Education and Research (Japanese-language courses)

» Renowned for offering high-quality language education

Since the time of its founding Sophia has emphasized foreign language education, and Sophia graduates are highly regarded for their exceptional language proficiency and communication skills. The Center for Language Education and Research offers courses in 22 languages to Japanese speaking students. The Center also provides a wide variety of Japanese courses for international students. In addition to fostering the ability to utilize foreign language proficiency as they pursue careers in an increasingly global and diverse world, Sophia University aims to lay the groundwork for students' ability to use foreign languages to logically develop their own ways of thinking, present their thoughts, and negotiate at a deeper level.



Academic and Research Institutes Organizations

Undergraduate Faculties and Departments / Centers Offering University-Wide Programs

JAPANESE-MEDIUM PROGRAMS	
Faculty of Theology	Theology
Faculty of Humanities	Philosophy
	History
	Japanese Literature
	English Literature
	German Literature
	French Literature
	Journalism
Faculty of Human Sciences	Education
	Psychology
	Sociology
	Social Services
	Nursing
Faculty of Law	Law
	International Legal Studies
	Legal Studies of the Global Environment
Faculty of Economics	Economics
	Management
Faculty of Foreign Studies	English Studies
	German Studies
	French Studies
	Hispanic Studies
	Russian Studies
	Luso-Brazilian Studies
Faculty of Global Studies	Global Studies
Faculty of Science and Technology	Materials and Life Sciences
	Engineering and Applied Sciences
	Information and Communication Sciences
ENGLISH-MEDIUM PROGRAMS	
Faculty of Liberal Arts	Liberal Arts
Faculty of Science and Technology	Materials and Life Sciences (Green Science Program)
	Engineering and Applied Sciences (Green Engineering Program)
GENERAL STUDIES COURSES / STUDY ABROAD PROGRAMS	
Center for Global Education and Discovery	
LANGUAGE	
Center for Language Education and Research	

Graduate Schools and Programs

JAPANESE-MEDIUM PROGRAMS	
Graduate School of Theology	Master's Program in Theology* Doctoral Program in Systematic Theology
Graduate School of Humanities	Philosophy History Japanese Literature English and American Literature German Literature French Literature Journalism Cultural Interaction
Graduate School of Applied Religious Studies	Death and Life Studies*
Graduate School of Human Sciences	Education Psychology Sociology Social Services Nursing*
Graduate School of Law	Law Juris Doctor Program (Law School)
Graduate School of Economics	Economics Management
Graduate School of Language and Linguistics	Linguistics
Graduate School of Global Studies	International Relations Area Studies
Graduate School of Science and Technology	Science and Technology Mechanical Engineering Electrical and Electronics Engineering Applied Chemistry Chemistry Mathematics Physics Biological Science Information Science
Graduate School of Global Environmental Studies	Global Environmental Studies
ENGLISH-MEDIUM PROGRAMS	
Graduate School of Human Sciences	Education
Graduate School of Global Studies	Global Studies
Graduate School of Languages and Linguistics	Linguistics (TESOL Course*)
Graduate School of Global Environmental Studies	International Graduate Course in Global Environmental Studies
Graduate School of Science and Technology	Science and Technology Green Science and Engineering

Research Institutes

Sophia Research Organization has two research divisions: 11 Research Institutes Division, 7 Project Research Division. Research activities are carried out in individual research units which are established under each of the two divisions. In addition, Sophia University has Affiliated Research Organizations contributing to different research fields.

RESEARCH INSTITUTES DIVISION	THE PROJECT RESEARCH DIVISION	AFFILIATED RESEARCH ORGANIZATIONS
Institute for Christian Culture	Nanotechnology Research Center	Kirishitan Bunko Library
Institute of Medieval Thought	Center for Islamic Studies	Monumenta Nipponica
Iberoamerican Institute	Sustainable Energy Research Center	Sophia Asia Center for Research and Human Development
Linguistic Institute for International Communication	Research and Development Center for CAE Technologies Applied for Next-generation Transport Aircraft Design	Institute of Grief Care
Institute of Global Concern (IGC)	Microwave Science Research Center	Semiconductor Research Institute
Institute of Comparative Culture	Water-Scarce Society Information & Research Center	Sophia University Institute of Bioethics
European Institute	Sophia Institute for Human Security	Human Resource Center for International Cooperation
Institute of Asian, African, and Middle Eastern Studies		Institute of International Relations
Institute of American and Canadian Studies		
Institute for Studies of the Global Environment		
Institute of Media, Culture and Journalism		

Distinctive Affiliated Research Organizations

Sophia University has long been acting as a cross-cultural bridge in the research field, and promoting internationalization of the study environment.

Kirishitan Bunko Library

Kirishitan Bunko is a world-famous center for the collection, study and publication of materials on early East-West relations and Christian missionary activities in Japan and Asia. The Kirishitan Bunko collection has approximately 15,600 volumes, including books, documents, maps, and materials published in Europe in the 16th and 17th centuries, Roman Catholic Church publications from the Meiji period, Petitjean editions, and other related materials. In recent years, the third edition of the “Kirishitan Bunko” bibliography and a virtual library of the Kirishitan Bunko Library rare book collection were released on the internet “Laures Kirishitan Bunko Rare Book Database and Virtual Library”.

(<https://digital-archives.sophia.ac.jp/laures-kirishitan-bunko/>)



Monumenta Nipponica

Monumenta Nipponica, first published in 1938, is one of the world's oldest English-language academic journals in the field of Asian studies. Since its founding, MN's mission has been to provide an international forum for the exchange of ideas and the presentation of recent research on Japan. As a peer-reviewed journal for researchers from across the globe, MN carries original scholarly articles on premodern and modern history, literature, art history, religion, and thought. The journal is also committed to providing a platform for translations of Japanese sources and texts—with several hundred such translations having appeared as of 2016—and to publishing authoritative reviews of recent books on Japan. Print subscriptions can be ordered from the MN office. From volume 60 (2005), the journal has been available online through Project MUSE (<https://muse.jhu.edu/>). The complete run of back issues is available online through JSTOR (<http://www.jstor.org/>).

(<http://dept.sophia.ac.jp/monumenta/>)



Sophia Asia Center for Research and Human Development

Sophia Asia Center for Research and Human Development was established in 1996 as an overseas educational institute in Cambodia, with the aim of pursuing Sophia University's mission through the development of knowledge and education in Asia. In cooperation with the Royal University of Fine Arts, training courses in Archaeology and Architecture are conducted for Cambodian students at the site of Banteay Kdei temple and the western causeway of Angkor Wat. In 2001, students of the Center helped rewrite the history of the Angkorian era when they discovered 274 Buddha statues dating back 1,000 years. In addition to field research, the Center hosts international symposiums, lectures, and workshops. The University has also opened the Sophia Angkor Center for Cultural Heritage Education, which offers excavation site tours and other programs for local scholarship students. In 2016, Cambodia and Japan commenced a four-year restoration project centered on the northern section of the Western Causeway of Angkor Wat. It is a project jointly initiated by the APSARA National Authority and Sophia University. In 2017, Professor Yoshiaki Ishizawa, a former President of Sophia and current Director of the Sophia Asia Center for Research and Human Development, was granted The Ramon Magsaysay Award.

(<http://dept.sophia.ac.jp/is/angkor/>)



Sophia University Overseas Partner Institutions

Student and Academic Exchange Agreements with 326 Institutions in 69 countries and regions

(As of April 1, 2018)

Sophia University has entered into student and academic exchange agreements with more than 320 unique institutions around the world. These agreements offer Sophia students the opportunity to spend part of their time as a student at another campus. In this way, Sophia, as an institution of higher learning, throws open its doors to the world.

Sophia University has accepted a total of 1,593 international students in the academic year 2017. On the other hand, 1,252 Sophia students have studied abroad throughout the year. Within the scheme of our exchange program, 483 were incoming students and 370 were outgoing students.

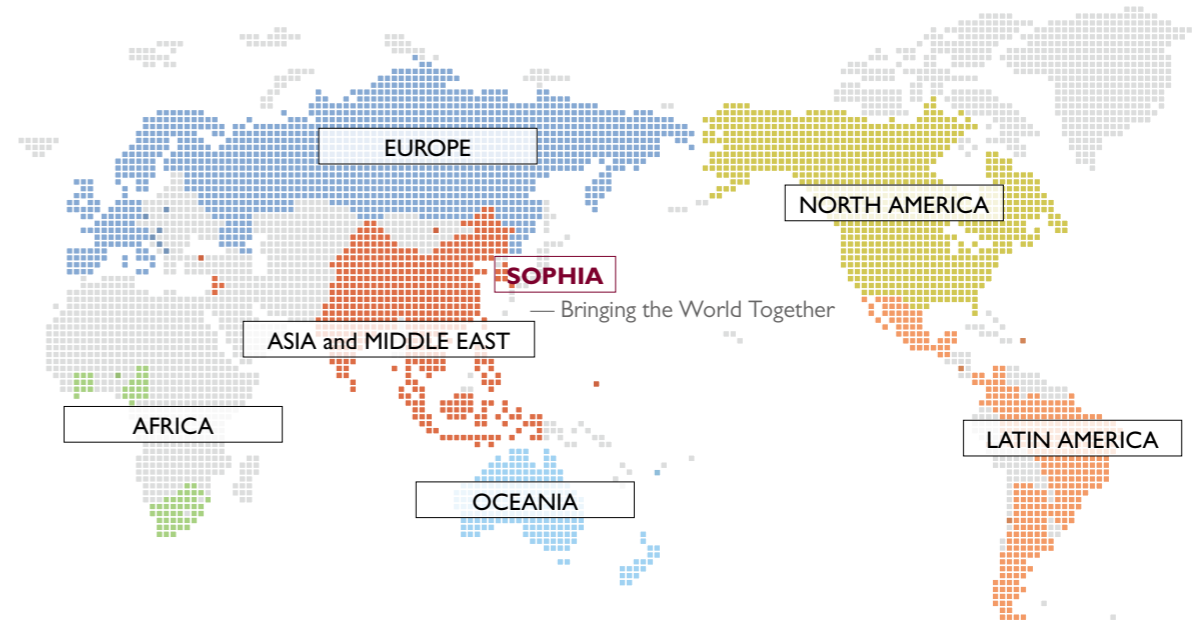

ASIA	
	Beijing Foreign Studies University
	Central University of Finance and Economics
	China Foreign Affairs University
	Fudan University
	Harbin Institute of Technology
	Nankai University
	Renmin University of China
	Tsinghua University
	Wuhan University
	Xiamen University
	The Chinese University of Hong Kong
	Hong Kong University of Science and Technology
	The University of Hong Kong
	City University of Hong Kong
	University of Macau
	Beijing International Studies University*
	Huazhong University of Science and Technology*
	Inner Mongolia University of Technology*
	University of Electronic Science and Technology of China*
	Yanshan University*
	Bogor Agricultural University (S)
	Universitas Gadjah Mada (S)
	Universitas Indonesia
	Petra Christian University
	Sanata Dharma University
	Universiti Kebangsaan Malaysia (S)
	University of Malaya
	Universiti Teknologi Malaysia
	University Utara Malaysia*
	Ateneo de Manila University (S)
	De La Salle University (S)
	University of the Philippines
	Singapore Management University
	Yale-NUS College
	Nanyang Technological University*
	Catholic University of Daegu
	Catholic University of Korea
	Hankuk University of Foreign Studies
	Pusan National University, College of Humanities
	Seoul National University
	Sogang University
	Sookmyung Women's University
	Yonsei University
	Fu Jen Catholic University
	National Chengchi University
	National Taiwan University
	Chiang Mai University
	Chulalongkorn University (S)
	Mahidol University (S)
	Thammasat University
	King Mongkut's University of Technology Thonburi*
	Khon Kaen University*
	Thai-Nichi Institute of Technology*
	Royal University of Fine Arts*
	Royal University of Phnom Penh*
	Assumption College*
	Kristu Jayanti College*
	Jadavpur University*
	Loyola College of Social Sciences*
	St. Aloysius College*
	St. Berchmans College*
	St. Joseph's College*
	St. Teresa's College*
	St. Xavier's College, Ahmedabad*
	St. Xavier's College, Kolkata*
	St. Xavier's College, Mumbai*
	National University of Laos*
	Mongolian University of Science and Technology*
	The University of Colombo*
	Foreign Trade University
	VNU University of Social Sciences and Humanities, Hanoi
	Can Tho University*

AFRICA	
	Université d'Abomey-Calavi
	University Ouaga II*
	Catholic University of Central Africa
	Centre de Recherche et d'Action pour la Paix
	Stellenbosch University

OCEANIA	
	The University of Adelaide
	Australian Catholic University
	Deakin University
	Griffith University
	La Trobe University
	Macquarie University
	The University of Melbourne
	The University of Notre Dame Australia
	The University of Queensland
	The University of Sydney
	University of Technology, Sydney
	The University of Western Australia
	University of Wollongong
	The University of the South Pacific
	College of Micronesia-FSM*
	The University of Auckland

Other Networks for Student Mobility
SAIMS (Sophia + ASEAN International Mobility for Students Program):
 Partner Universities—7 universities from 4 ASEAN countries.
 URL <http://dept.sophia.ac.jp/pj/saims>

ACUCA (The Association of Christian Universities and Colleges in Asia)
SMS (Student Mobility Scheme):
 41 partner institutions are participating in ACUCA SMS from 8 countries/regions, namely Hong Kong, India, Indonesia, Japan, Korea, the Philippines, Taiwan and Thailand.
 URL <http://www.acuca.net/>

NORTH AMERICA	
	University of Alberta
	The University of British Columbia
	King's University College at the University of Western Ontario
	Université Laval
	McGill University
	University of Victoria
	Université de Montréal
	Arizona State University
	University of Arizona
	Boston College
	California State University, Fullerton
	Canisius College
	The Catholic University of America
	Clemson University
	The University of Connecticut
	Creighton University
	University of Colorado at Boulder
	DeSales University
	Duquesne University
	Fairfield University
	Fordham University
	George Mason University
	Georgetown University
	University of Georgia
	Gonzaga University
	Haverford College
	University of Hawai'i at Manoa
	College of the Holy Cross
	John Carroll University
	The University of Kansas
	Le Moyne College
	Loyola Marymount University
	Loyola University Chicago
	Loyola University New Orleans
	Marquette University
	University of Massachusetts Amherst
	University of Massachusetts Boston
	University of Miami
	University of Minnesota
	The University of Mississippi

	University of Missouri-Columbia
	University of Montana
	The New School
	University of North Carolina at Chapel Hill
	University of North Carolina at Charlotte
	North Carolina State University
	University of North Florida
	Northwest Missouri State University
	Occidental College
	Pace University
	University of Pennsylvania
	The University of Pittsburgh
	University of Portland
	Saint Mary's College of California
	Saint Peter's University
	San Diego State University
	University of San Francisco
	Santa Clara University
	The University of Scranton
	Seattle University
	Seton Hall University
	St. John's University (NY)
	St. Joseph's University
	St. Mary's University
	St. Norbert College
	University of St. Thomas
	Suffolk University
	Tennessee Tech University
	The University of Texas at Austin
	University of Virginia
	Washington and Jefferson College
	University of West Florida
	University of West Georgia
	University of Wisconsin-Madison
	University of Wisconsin-Whitewater
	Wittenberg University
	Xavier University
	Yale University
	York College of Pennsylvania
	The University of California, Berkeley*
	The George Washington University*

LATIN AMERICA	
	Universidad Católica de Córdoba (L)
	Universidad del Salvador (L)
	Universidade de Brasília (L)
	Universidade Estadual de Campinas (L)
	Pontificia Universidade Católica do Rio Grande do Sul
	Pontificia Universidade Católica de São Paulo (L)
	Universidade de São Paulo
	Pontificia Universidad Católica de Chile (L)
	Pontificia Universidad Javeriana (L)
	Universidad de los Andes (L)
	University for Peace*
	Universidad de Guadalajara
	Universidad de Guanajuato (L)
	Universidad Iberoamericana Ciudad de Mexico (L)
	Instituto Tecnológico Autónomo de México (L)
	Instituto Tecnológico y de Estudios Superiores de Monterrey
	Instituto Tecnológico y de Estudios Superiores de Occidente (L)
	Universidad Nacional Autónoma de México
	Pontificia Universidad Católica del Perú (L)
	Universidad Católica del Uruguay
	The University of West Indies*

Other Networks for Student Mobility
LAP (Sophia-Nanzan Latin America Program):
 Joint program with Nanzan University and Sophia Junior College
 Partner Universities—13 universities from 6 Latin American countries.
 URL <https://www.sophia-nanzan-lap.com/>

* Academic Exchange Only ** Department Level Exchange Only (S) SAIMS Partner Universities (L) LAP Partner Universities

Sophia University Overseas Partner Institutions

EUROPE	
 Karl-Franzens-Universität Graz	 European University Viadrina
 Belarusian State University	 Albert-Ludwigs-Universität Freiburg
 Universiteit Antwerpen	 Ruprecht-Karls-Universität Heidelberg
 Université Catholique de Louvain	 Universität zu Köln
 Université de Namur	 Hochschule Ludwigshafen am Rhein
 University of Sarajevo*	 Martin-Luther-Universität Halle-Wittenberg
 Anglo-American University	 Hochschule für Philosophie München
 The Zagreb School of Economics and Management	 Universität Paderborn
 Aarhus University	 Universität Rostock
 Aalto University School of Business	 Universität des Saarlandes
 Hanken School of Economics	 Technische Hochschule Nuernberg Georg Simon Ohm
 Université d'Aix-Marseille	 Universität Trier
 Université d'Angers	 Eberhard Karls Universität Tübingen
 Université Catholique de l'Ouest in Angers	 Universität Witten/Herdecke
 EAC Group Business School of Arts, Culture and Luxury	 Universität Hamburg**
 Burgundy School of Business	 Universität Bamberg**
 Ecole Supérieure des Sciences Commerciales D'Angers	 Universität Duisburg-Essen**
 France Business School (ESCEM)	 Universität Erfurt**
 Université de Franche-Comté, Besançon	 Universität München**
 Institut Catholique de Paris	 Universität Würzburg**
 Institut d'Etudes Politiques de Grenoble	 The University of Pécs
 Institut d'Etudes Politiques de Paris	 University of Iceland
 Institut National des Langues et Civilisations Orientales	 Dublin City University
 NEOMA Business School	 Università di Cagliari
 Université Catholique de Lille	 Università Carlo Cattaneo
 Université Catholique de Lyon	 Università Ca' Foscari Venezia
 Université Pantheon-Assas Paris II	 Università degli studi di Napoli "L'Orientale"
 Université Paris X Nanterre	 Università di Roma "La Sapienza"
 Université Bordeaux Montaigne	 Università per Stranieri di Perugia*
 Université Lille 3	 Al-Farabi Kazakh National University
 Université Jean Moulin Lyon 3	 University of Prishtina*
 Université de Strasbourg	 University of Liechtenstein
 ESSEC Business School	 Vilnius University
 Institut Catholique de Toulouse	 Vytautas Magnus University
 Ecole Francaise D'Extreme-Orient*	 Université du Luxembourg
 Universität Bayreuth	 Ss. Cyril and Methodius University in Skopje*
 Rhenish Friedrich-Wilhelm University Bonn	 University of Oslo
 Freie Universität Berlin	 Warsaw University of Technology**
 Technische Universität Berlin	 Universidade de Aveiro
 Bremen University of Applied Sciences	 Universidade de Coimbra
 Heinrich Heine University Düsseldorf	 Universidade do Minho
 Katholische Universität Eichstätt-Ingolstadt	 Universidade do Porto
	 Far Eastern Federal University
	 Herzen State Pedagogical University of Russia
	 Moscow State University
	 Moscow State Linguistic University
	 Petrozavodsk State University
	 Ryazan State University
	 Saint Petersburg State University
	 Saint-Petersburg State University of Culture
	 Voronezh State University
	 University of Ljubljana
	 Universitat Autònoma de Barcelona
	 Universidad de Burgos
	 Universidad Católica de Valencia San Vicente Mártir
	 Universidad Pontificia Comillas
	 Universidad de Deusto
	 Universidad de Jaén
	 Universidad Autónoma de Madrid
	 Universidad Loyola Andalucía
	 Universidad de Salamanca
	 Universidad de Sevilla
	 Universitat de València
	 Uppsala Universitet
	 The Graduate Institute of International and Development Studies
	 Université de Genève
	 Universität St.Gallen
	 Zurich University of Applied Sciences**
	 University of Amsterdam, Faculty of Social and Behavioural Sciences
	 Leiden University
	 Rotterdam Business School
	 The University of Birmingham
	 University of East Anglia
	 The University of Edinburgh
	 University of Hertfordshire
	 University of Leeds
	 Newcastle University
	 The University of Reading
	 The University of Stirling
	 University of London the School of Oriental and African Studies
	 The University of Sheffield
	 St Mary's University Twickenham London
	 Birkbeck, University of London*
	 Liverpool Hope University*
	 Tashkent State Institute of Oriental Studies

* Academic Exchange Only ** Department Level Exchange Only

Support for International Students

Bilingual Campus

All departments at Sophia University have staff members who speak English, allowing them to accommodate English-language inquiries related to student life, including questions about coursework and registration, scholarship programs, and counseling. Administrative offices that deal with international students have formed the Support Network for International Students as part of an effort to integrate support services for those students.

Center for Global Education and Discovery

The Center for Global Education and Discovery offers various global education programs to all students at the University in order to foster global competency.

- General Studies Courses in Japanese and English
- Internship Programs (credit-based)
- Global Competency Program
- Exchange Programs
- Short-term Study Abroad Programs
- Short-term Programs for International Students
- Social Engagement Programs
- Sophia AIMS Program (SAIMS)
- Sophia-Nanzan Latin America Program (LAP)

Center for Language Education and Research

The Center for Language Education and Research strives to offer language education to all students at the University in order to foster academic and communication skills. This mission includes operating the Language Learning Commons (LLC) to provide language-learning support programs to international students, including:

- Japanese Language Learning Support Sessions
- Kanji Marathon
- Language Exchange
- Books and DVDs related to language learning purposes

Career Support

The Sophia Career Center helps International students to make their job-seeking efficient and gives them tips to find career opportunities in Japan.

International students have access to the following programs offered by the Career Center:

- Individual counseling service
- Job search database (including internship search)
- Job fair
- Job search workshops designed for international students

Sophia graduates of foreign nationality work in many multinational corporations, including:

- | | |
|---------------------------------|--------------------------|
| All Nippon Airways Co., Ltd. | Goldman Sachs |
| Hakuhodo Incorporated | Ernst & Young |
| Fuji Xerox Co., Ltd. | General Electric Japan |
| IBM Japan, Ltd. | Kao Corporation |
| Marubeni Corporation | Morgan Stanley |
| NEC Corporation | Nestle Japan Ltd. |
| Nomura Securities Co., Ltd. | NTT DATA Corporation |
| Sumitomo Chemical Co., Ltd. | Canon Inc. |
| Takeda Pharmaceutical Co., Ltd. | Toyota Motor Corporation |

GL-NET

GL-Net is a volunteer group of Sophia University students organizing various activities to enhance the interaction between Japanese and international students by cooperating with the Center for Global Education and Discovery.

Prayer Rooms and Halal Food Restaurant

Sophia University provides Muslim students and faculty members with prayer rooms and Halal Food restaurant.

Sophia Student Integration Commons (SSIC)

SSIC provides a space for promoting interaction and communication between students, especially international and Japanese students. It is also used as a place where students can talk to peer students to express and consult their concerns about university life.

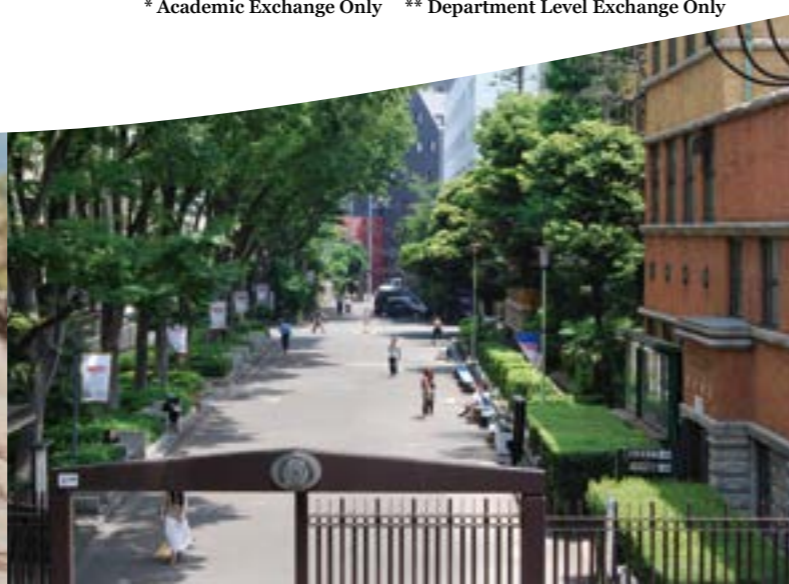

Support for International Students

Housing

Sophia University has four dormitories:

Sophia Soshigaya International House

[Men's and Women's]

Sophia Soshigaya International House is a dormitory where students have opportunities to meet people of different cultures and language backgrounds. The House aims to influence the personal growth of the students by providing an environment where they can live close together in a unique residential community. The House expects students with strong motive to international exchange and to actively participate in the House activities, as well as complying with regulations and rules of the House. The House has a total of 330 rooms including rooms for families of overseas teachers and researchers.

Location: Kami-Soshigaya, Setagaya-ku, Tokyo

Commuting time to Sophia: approx. 50 min.

Meals: not provided (shared kitchen available)

Monthly rent: 42,000 yen (as of 2017)

Other fees: Dorm admission fee (42,000 yen), deposit (42,000 yen - refundable), utility costs etc.

Sophia Kasai International House Women's Dormitory

Location: Naka-Kasai, Edogawa-ku, Tokyo

Commuting time to Sophia: approx. 40 min.

Meals: not provided (shared kitchen available)

Monthly rent: 55,100 yen (as of 2017)

Other fees: Entrance fee, deposit electricity, maintenance fee, etc.

Sophia Higashi Nakano Women's Dormitory

Location: Higashi-Nakano, Nakano-ku, Tokyo

Commuting time to Sophia: approx. 20 min.

Meals: students can choose a room with board, or a room without meals. (individual kitchen available)

Monthly rent: 106,800 yen to 123,900 yen (as of 2017)

Other fees: Entrance fee, deposit, maintenance fee, etc.

Sophia Edagawa Men's Dormitory

[Basic Japanese skills required]

Location: Edagawa, Koto-ku, Tokyo

Commuting time to Sophia: approx. 35 min.

Meals: not provided (individual kitchen available)

Monthly rent: 70,000 yen (as of 2017)

Other fees: Entrance fee (100,000 yen), deposit (100,000 yen - refundable), utility costs

There are also several affiliated dormitories available in the suburbs of Tokyo.

Scholarships for International Students

Scholarship Name	Eligible Students	Description	Stipend
Sophia University New Students Scholarship	New Degree students (undergraduate)	This scholarship is awarded to students with excellent grades at their previous school who have Sophia as their first choice of university, but who would find it difficult to study here due to financial hardship.	Full, half or one third of tuition
Sophia University Graduate School New Students Scholarship	New Degree students (graduate)	This scholarship is awarded to students with excellent grades at their previous school who have Sophia as their first choice of graduate school, but who would find it difficult to study here due to financial hardship.	Full, half or one third of tuition
Sophia University Tuition Support Scholarships for Privately-Funded International Students	Degree students (undergraduate and graduate)	This scholarship is for undergraduate and graduate students who experience financial hardship that makes it difficult to continue their studies despite tremendous motivation.	Full, half or one third of tuition
Sophia University Benefactors' Scholarships	Degree students (undergraduate and graduate)	Benefits come from the funds created by the contributions of benefactors in Japan and overseas, and are given to full-time degree students who meet each benefactor's intention. The scholarships are for one year. However, students may be selected more than once. As a rule, each Sophia University Benefactors' Scholarship may be awarded concurrently to a recipient as long as the total amount awarded does not exceed the value equivalent to the annual school fee.	Depends on the scholarships





English-Taught Degree Programs

Faculty of Liberal Arts

OVERVIEW

As a pioneer of international education in Japan for more than half a century, the Faculty of Liberal Arts provides a liberal arts education in English that fosters wide-ranging knowledge and logical thinking skills. During the first year, students develop their writing and analytic skills, and take introductory courses in a range of academic disciplines. Students major in one of the three specialized fields (Comparative Culture, Social Studies, International Business and Economics) from the second half of their sophomore year. By developing advanced language skills, outstanding expertise and proficiency in intercultural communication, we educate "globally competent" individuals who can play active roles in international organizations, multinational enterprises, and other globally active organizations.

DEGREES AND MAJORS

Degree: Bachelor of Arts in Liberal Arts
 Majors: Comparative Culture, Social Studies,
 International Business and Economics

ACADEMIC SCHEDULE

Spring semester: April to August
 Autumn semester: September to March

PROGRAM DURATION

Freshman: 4 years
 Transfer students (Junior): 2 years

NUMBER OF STUDENTS ADMITTED PER YEAR

Spring admission: 63 students
 Autumn admission: 82 students

ADMISSION INFORMATION

- **Application schedule:**
 Spring (April) entry:
 1st application period: late August to mid-September
 2nd application period: late November to mid-December
 Autumn (September) entry:
 1st application period: late November to mid-December of the previous year
 2nd application period: late March to mid-April

- **Method of screening:**
 Document screening

- **Application fee:**
 35,000 yen

- **Application materials:**
 1. Application forms & essay
 2. Official high school transcript(s)
 3. Certificate of graduation
 4. SAT scores or ACT scores or IB diploma
 5. TOEFL or IELTS scores
 6. Two letters of recommendation

TUITION AND FEES FOR THE FIRST YEAR (as of 2018)

All figures shown in Japanese yen

Entrance fee (once at matriculation)	200,000
Tuition fee (assuming 31 credits) *	982,700
Other fees	292,450
Total	1,475,150

* Tuition fee is 31,700 yen per credit and the total amount varies according to the number of credits.

Admission URL:
<https://www.sophia.ac.jp/eng/admissions/>

Program URL:
https://www.sophia.ac.jp/eng/program/undergraduate_c/UG_LA/

Faculty of Science and Technology

Green Science and Green Engineering Programs

OVERVIEW

To meet the diverse needs of internationalization, the Faculty of Science and Technology added two English-medium programs as part of its regular curriculum in 2012. Each program deals with environmental technologies in the following areas of study. Green Science Program at the Department of Materials and Life Sciences covers Physics, Chemistry, Biochemistry and Material Engineering. Green Engineering Program at the Department of Engineering and Applied Science covers Physics, Electrical Engineering and Mechanical Engineering. Class sizes are kept small so that students can communicate closely with their instructors. The aim of these programs is to foster science and technology specialists with crossdisciplinary knowledge to challenge global environmental issues.

DEGREES AND MAJORS

Degrees: Bachelor of Science in Materials and Life Sciences
 Bachelor of Science in Engineering and Applied Sciences
 Majors: Green Science, Green Engineering

ACADEMIC SCHEDULE

Autumn semester: September to March
 Spring semester: April to August

PROGRAM DURATION

Freshman: 4 years
 Transfer students (Junior): 2 years

NUMBER OF STUDENTS ADMITTED PER YEAR

Green Science: 25 students
 Green Engineering: 25 students

ADMISSION INFORMATION

- **Application schedule:**
 Autumn (September) entry:
 1st application period: late November to mid-December of the previous year
 2nd application period: late March to mid-April

- **Method of screening:**
 Document screening

- **Application fee:**
 30,000 yen

- **Application materials:**
 1. Application forms & essay
 2. Official high school transcript(s)
 3. Certificate of graduation
 4. SAT scores, ACT scores, IB diploma or EJU scores
 5. TOEFL or IELTS scores
 6. Two letters of recommendation

TUITION AND FEES FOR THE FIRST YEAR (as of 2018)

All figures shown in Japanese yen

Entrance fee (once at matriculation)	200,000
Tuition fee	1,098,000
Other fees	447,950
Total	1,745,950

Admission URL:
<https://www.sophia.ac.jp/eng/admissions/>

Program URL:
<http://www.st.sophia.ac.jp/english/>



M.A. and Ph.D. in Global Studies

OVERVIEW

The Graduate Program in Global Studies emphasizes inquiry into global processes in the contemporary world and their historical antecedents. The program offers three specialized fields; 1) The M.A. and Ph.D. in Global Studies focus on the study of global issues and processes from social science perspectives; 2) The M.A. in International Business and Development Studies emphasizes the acquisition of analytical skills to deal with a range of contemporary global business and development programs, with a strong focus on Japan and Asia; 3) The M.A. and Ph.D. in Japanese Studies offers an integrated and interdisciplinary approach to the study of both historical and contemporary aspects of Japanese history, literature, religion, art history, society, and culture. Qualified students may pursue a dual M.A. in Japanese Studies offered by Sophia University and SOAS (School of Oriental and Asian Studies, University of London). The program's small scale and the broad experience and research interests of faculty members enable flexible course selection.

DEGREES

M.A. in Global Studies
 M.A. in International Business and Development Studies
 M.A. in Japanese Studies
 Ph.D. in Global Studies
 Ph.D. in Japanese Studies

ACADEMIC SCHEDULE

Spring semester: April to August
 Autumn semester: September to March

PROGRAM DURATION

M.A. program: 2 years
 Ph.D. program: 3 years

NUMBER OF STUDENTS ADMITTED PER YEAR

M.A. 30 students
 Ph.D. 3 students

ADMISSION INFORMATION

Application schedule:

Spring (April) entry:
 Application period: late August to mid-September
Autumn (September) entry:
 Application period: late March to mid-April

Method of screening:

Document screening, interview (if needed)

Application Fee:

35,000 yen

Application materials:

1. Application forms
2. Essay(s)
3. Official university transcripts
4. Proof of graduation
5. TOEFL or IELTS scores
6. Three letters of recommendation
7. Copy of a thesis or a significant paper

TUITION AND FEES FOR THE FIRST YEAR (as of 2018)

All figures shown in Japanese yen

	M.A.	Ph.D.
Entrance fee (once at matriculation)	200,000	200,000
Tuition fee	480,000	451,000
Other fees	241,400	152,100
Total	921,400	803,100

Admission URL:
<https://www.sophia.ac.jp/eng/admissions/>

Program URL:
<http://gpgs fla.sophia.ac.jp/>

M.A. and Ph.D. in Global Environmental Studies

OVERVIEW

The Graduate Program in Global Environmental Studies focuses specifically on the environmental problems that constitute one of the greatest challenges we face today. The curriculum for the International Graduate Course in Global Environmental Studies (IGCGES) consists of three fields: 1) Economics and Business Administration for the Environment; 2) Law, Politics and Sociology for the Environment; 3) Science and Engineering for the Environment. One of the strategies of IGCGES is to enhance the capacity of students to contribute to the solving of current environmental issues through a variety of practical and discipline-specific programs. The school is devoted to creating graduates equipped to serve effectively as business persons, specialists, or scholars in the area of environmental protection.

DEGREES

M.A. in Environmental Studies
 Ph.D. in Environmental Studies

ACADEMIC SCHEDULE

Spring semester: April to August
 Autumn semester: September to March

PROGRAM DURATION

M.A. program: 2 years
 Ph.D. program: 3 years

NUMBER OF STUDENTS ADMITTED PER YEAR

M.A. 30 students
 Ph.D. 10 students

ADMISSION INFORMATION

Application Schedule:

Spring (April) entry:
 Application period: late August to mid-September
 (Additional application period: December *)

Autumn (September) entry:

Application period: late March to mid-April
 (Additional application period: mid-June to early July *)
 * The additional application period is only for Ph.D. applicants who hold valid status of residence in Japan.

Method of screening:

Document screening, interview (if needed)

Application fee:

35,000 yen

Application materials:

1. Application form
2. Statement of purpose (500-700 words)
3. Official university transcripts
4. Proof of graduation
5. TOEFL or IELTS scores
6. Letter(s) of recommendation (M.A.: 1 letter/Ph.D.: 3 letters)
7. Copy of a thesis or a significant paper

TUITION AND FEES FOR THE FIRST YEAR (as of 2018)

All figures shown in Japanese yen

	M.A.	Ph.D.
Entrance fee (once at matriculation)	200,000	200,000
Tuition fee	591,000	517,000
Other fees	241,400	152,100
Total	1,032,400	869,100

Admission URL:
<https://www.sophia.ac.jp/eng/admissions/>

Program URL:
<http://www.genv.sophia.ac.jp/english/>



M.S. and Ph.D. in Green Science and Engineering

OVERVIEW

The Graduate School of Science and Technology was established in 1962, and currently has one interdisciplinary graduate program with nine divisions. The Green Science and Engineering Division was launched in 2013. The entire educational program, including lectures and research guidance, is conducted in English. In addition, emphasis is given to environment and sustainability-related studies, which are vital to the future of humankind.

To foster cross-disciplinary education, faculty members from the eight divisions (Mechanical Engineering, Electrical and Electronics Engineering, Applied Chemistry, Chemistry, Mathematics, Physics, Biological Science, Information Science) will be involved in teaching and research guidance. At the same time, by joining the research group of the faculty member of their choice, students can receive research guidance and pursue much more advanced research work.

DEGREES

M.S. in Green Science and Engineering
Ph.D. in Green Science and Engineering

ACADEMIC SCHEDULE

Spring semester: April to August
Autumn semester: September to March

PROGRAM DURATION

M.S. program: 2 years
Ph.D. program: 3 years

NUMBER OF STUDENTS ADMITTED PER YEAR

M.S. 20 students
Ph.D. 3 students

ADMISSION INFORMATION

Application schedule:

Spring (April) entry: late August to mid-September *
Autumn (September) entry: late March to mid-April
* Spring entry is only for Ph.D. applicants.

Method of screening:

Document screening, interview (if needed)

Application fee:

35,000 yen

Application Materials:

1. Application form
2. Statement of purpose (500-700 words)
3. Official university transcripts
4. Proof of graduation
5. TOEFL or IELTS scores
6. Three letters of recommendation
7. Copy of a thesis or a significant paper or publications (optional)

TUITION AND FEES FOR THE FIRST YEAR (as of 2018)

	All figures shown in Japanese yen	
	M.S.	Ph.D.
Entrance fee (once at matriculation)	200,000	200,000
Tuition fee	946,000	501,000
Other fees	451,900	322,600
Total	1,597,900	1,023,600

Admission URL:
<https://www.sophia.ac.jp/eng/admissions/>

Program URL:
<http://www.st.sophia.ac.jp/english/>

M.A. in Linguistics (TESOL: Teaching English to Speakers of Other Languages)

OVERVIEW

The Master's Program in TESOL started in 2006 with the aim of educating and training both pre-service and in-service teachers in teaching English as a foreign language. The program emphasizes not only practical but also theoretical aspects of English education, with a particular view to helping students develop the type of professionalism that will enable them to cater to the needs and wants of Japanese students studying in an EFL environment. Influenced in many positive ways by research and educational development overseas, the program presents a unique educational experience for students as they try to make a difference in English education in Japan. Upon completing the program, most of our graduates choose to work as practicing teachers in Japan and other parts of the world.

DEGREE

M.A. in Linguistics

ACADEMIC SCHEDULE

Spring semester: April to August
Autumn semester: September to March

PROGRAM DURATION

2 years

NUMBER OF STUDENTS ADMITTED PER YEAR

33 students
(including other Linguistics courses taught in Japanese)

ADMISSION INFORMATION

Application schedule:

Spring (April) entry
1st application period: July
2nd application period: December

Method of screening:

Document screening and interview

Application fee:

35,000 yen

Application Materials:

1. Application form
2. Statement of purpose (maximum 2000 words)
3. Official university transcripts
4. Proof of graduation
5. Prerequisite certification (if necessary)
6. One letter of recommendation
7. TOEFL or IELTS scores (for non-native speakers of English)

TUITION AND FEES FOR THE FIRST YEAR (as of 2018)

	All figures shown in Japanese yen	
	M.A.	
Entrance fee (once at matriculation)	200,000	
Tuition fee	480,000	
Other fees	241,400	
Total	921,400	

Admission URL:
<https://www.sophia.ac.jp/eng/admissions/>

M.A. and Ph.D. in Education

OVERVIEW

Educational science (kyoiku-gaku in Japanese) is a comprehensive field of inquiries addressing complex dimensions of human growth and development. It examines educational phenomena from various perspectives and disciplines, including philosophy, history, sociology, political science, and psychology. One of the strengths of our department lies in its approach to compare policies and practices across different times and locations in order to gain meaningful insights into the nature of education. We currently accept applicants whose research interests lie in the field of Comparative and International Education or Education and International Development.

DEGREES

M.A. in Education
Ph.D. in Education

ACADEMIC SCHEDULE

Spring semester: April to August
Autumn semester: September to March

PROGRAM DURATION

M.A. program: 2 years
Ph.D. program: 3 years

NUMBER OF STUDENTS ADMITTED PER YEAR

M.A. 10 students
Ph.D. 5 students

ADMISSION INFORMATION

Application schedule:

Spring (April) entry
1st application period: July *

2nd application period: December

*1st application is only for M.A. applicants.

Method of screening:

M.A. Written examination, document screening and interview
Ph.D. Document screening and interview

Application fee:

35,000 yen

Application Materials:

1. Application form
2. Research Proposal (800 words)
3. Official university transcripts
4. Proof of graduation
5. One letter of recommendation (optional)
6. TOEFL/IELTS/TOEIC/Eiken scores (for non-native speakers of English)
7. Research paper on Education (4,000 words)/
Bachelor's Thesis/Master's Thesis

TUITION AND FEES FOR THE FIRST YEAR (as of 2018)

	All figures shown in Japanese yen	
	M.A.	Ph.D.
Entrance fee (once at matriculation)	200,000	200,000
Tuition fee	480,000	451,000
Other fees	241,400	152,100
Total	921,400	803,100

Admission URL:
<https://www.sophia.ac.jp/eng/admissions/>

International Student Voices



Faculty of Economics
Ayursed Ichinkhorloo [Mongolia]



Faculty of Liberal Arts
Giyoung Yun [Korea]



Faculty of Liberal Arts
Hunter Carpenter [U.S.A.]



M.A. in Green Science and Engineering
Emir Yilmaz [Turkey]



M.A. in Global Environmental Studies
Cecilia Ratemo [Kenya]



M.A. in Global Studies
Alberto Carrasco Lara [Mexico]

After graduating from the University of Finance and Economics in Mongolia and taking Japanese language courses while living in Osaka for three years, I transferred to Sophia University as a junior student. The reason I chose Sophia is the university's characteristic wide diversification of international students compared to other universities. Currently, I am living in Sophia Soshigaya International House where both Japanese and foreign students live together. There, we study, cook and hang-out together, and we have many opportunities to make friends from all around the world.

At the Department of Economics, I'm taking economics classes in both Japanese and English. I have found it a great merit to be able to communicate in both languages. It brings me more learning opportunities and supports my personal growth. With the university-wide general studies course, I took the opportunity to do an internship at JICA (Japan International Cooperation Agency). I was assigned to assist the training program for local staff of JICA overseas offices, and I was able to experience a unique Japanese working style and company culture. I was amazed by their professional attitudes and passion towards their work. This internship was a once in a lifetime experience and it really motivated me to study much harder.

Sophia University offers diverse courses that allow students to find for themselves whatever they want to study. I majored in International Business and Economics at the Faculty of Liberal Arts, and it provides me various selection of focusing more on a certain subject by taking intermediate and advanced courses. I also had chances to learn literature, art, religion, and philosophy that I was not familiar with, which helped expand my perspective and knowledge in those fields. As well as lecture courses, Sophia University provides opportunities for students to learn or experience outside the classrooms. I worked on a project which aimed to prepare entrepreneurial initiatives and to carry a plan into action applying the knowledge that I gained from courses at Sophia University. Successfully, I made a profit from the project and contributed to society by donating all the profit to the Fukushima Prefectural Government. Even though the project was only for one year with limited budget, I had an invaluable experience.

As I reach the final stage at Sophia University, I am planning to apply to accounting positions and studying to become a certified public accountant. Making the decision to study at Sophia University has not only given me knowledge in my major, but also changed every aspect of my life. I am truly grateful for all the support I received. Studying at Sophia University was the best decision I ever made.

Since childhood, Japan, with its rich culture, language, and history, has never left the forefront of my imagination. Therefore, as an exchange student from the University of Miami, I could not have been more thrilled to embark upon this adventure. For students of all backgrounds, Sophia University provided all of the ingredients for a successful, exciting experience. Its prime location and variety of courses dealing with all aspects of Japanese society and the world around it are just some of the highlights Sophia offers to students. However, what led me to pursue my studies at Sophia was its international character and charm. Interacting and becoming close friends with other students from all over the world, including Japan, has been the highlight of my experience thus far.

In my first semester, I could take courses that covered all of core subject areas, such as international marketing, Japanese civilization, and intermediate Japanese. Learning Japanese while being immersed in it on a daily basis has advanced my proficiency to levels I would not have been able to achieve back at my home university. Tokyo is a hub of international trade and business activity, making it a unique place to apply the knowledge learned in my international business classes. However, learning happens both inside and outside of the classroom. Everyday experiences and interactions are just important as note-taking and studying, and Sophia provides ample opportunities for all of these experiences.

As an engineering student specializing in intake manifolds for diesel engines, I am now having a great time working on my research project and preparing to give a presentation at an academic conference. Sophia University offers practical training programs to international students, and I had the opportunity to do an internship at UD Trucks, which is a joint-venture in the Volvo Group. This internship was provided by the Academic Partner Program between Sophia and the Volvo Group.

I was appointed to the Chassis & Vehicle Dynamics Engineering team. My main focus was on new medium duty trucks, designed for the Japanese market. I have attended meetings with Japanese engineers and engineers from other plants, such as France and Sweden, and was given tasks to understand the design and the project's concept more clearly.

I believe this internship at UD Trucks was a great opportunity for me to observe and experience work life in Japan. Before doing this internship, I have always told myself that I would go back to my home country after graduating from my Master's degree at Sophia University. However, now, if I can manage to find a job in Japan after graduating, I believe it would be a lot more beneficial for my future career in the automotive sector. I am glad that my studies in Sophia University and this internship program allowed me to discover what I want to accomplish in my career.

Sophia is considered one of the most unique universities in Japan as it offers its courses in both English and Japanese. International students can therefore easily join and pursue their studies without worrying about language. Besides, if students are concerned about daily communication outside of Sophia, they can attend Japanese courses depending on their language level.

Having a background in Environmental Science in Kenya, I felt that I needed more exposure from a global point of view. Professors at Sophia are friendly. They mentor students and one can seek more advice for research/thesis work. My research is assessing climate change impacts on water quality and fisheries in Lake Turkana, Kenya. Having gained more practical skills on data collection, analysis and presentation, I believe I will be able to help develop my country, in particular the arid areas. Other than research, I have been able to undertake various study trips around Japan related to the environment. I managed to visit Minamata, Kumamoto prefecture, which was a good outdoor study lesson that gave me hands-on experience highlighting the importance of having sound rules and regulations to monitor industrial activities. Having graduated from my Master's program, I intend to advance my studies through joining the Doctoral program. And being a strong advocate for the environment, I would love to be in a position where I can not only actively participate in environmental conservation activities, but also influence environmental policy.

In the spring of 2014, I had the opportunity to participate in the exchange program of my alma mater Ibero University. My experience at Sophia, although brief at that time, completely surpassed my expectations. I had the opportunity to meet amazing professors and prepare for an academic future. When the time came to choose a place for my graduate studies, the choice was very clear to me. Thus, in 2015 I enrolled in the graduate program in Global Studies (Japanese Studies). My major field of research and academic interest is Art History, and Sophia has a world-class faculty. This not only made Sophia my first choice, it has allowed me to develop myself in academia, within the field of art history through the mentorship of major experts, which allowed me to bring a strong interdisciplinary approach to my research and studies as a young art historian.

I believe Sophia is very rich, with an active faculty that almost weekly hosts internationally renowned scholars, who constantly contribute to academic discussions, both in Japan and abroad. However, the professors are not the only thing that Sophia has to offer, but also its community as a whole. I have found in Sophia a vibrant and international community, friends from all kinds of backgrounds, and colleagues that continually inspire me to pursue my studies.



Short-Term Study Options for International Students

EXCHANGE PROGRAM

Students at overseas universities with which Sophia University has a formal exchange agreement receive reciprocal treatment regarding credits and tuition fees. Exchange students can study at Sophia for one or two semesters from September or April. Internal screening will be conducted at their home institutions approximately six to eight months before the beginning of the exchange period. They must first meet the application requirements and pass the internal selection process to be nominated to the exchange program. For a list of our exchange partner institutions, please see pages 6-8.



NON-DEGREE PROGRAM

International students who wish to study for one or two semesters and earn credits as full-time students can apply for Sophia University as non-degree students. Non-degree students are to enroll in the Faculty of Liberal Arts (FLA), or the Center for Language Education and Research (CLER). They will take undergraduate courses and obtain credits but do not intend to receive an academic degree at Sophia. Applicants are required to choose one of the following tracks at the time of application.

Course offerings:

(1) English Track (FLA):

- Art History •Literature •Religion •Microeconomics
- Financial Management •Accounting •Marketing
- International Business •Social Studies •Anthropology
- Sociology •History •Political Science •Politics
- International Relations •Linguistics
- Regular Japanese Language Courses (Japanese 1-4, Advanced, Reading & Writing, Translations, Academic Japanese)

For more information about course listings, please refer to the FLA website: https://www.sophia.ac.jp/eng/program/undergraduate_c/UG_LA/

(2) Japanese Intensive Track (CLER):

- Intensive Japanese 1-4

This track is for students who wish to take the Japanese Language Intensive Program (JLIP). JLIP classes are scheduled for three hours a day (9:15 to 12:30) from Monday through Friday. English is occasionally used for instruction when necessary. There are four levels, and the lowest level is for students with a level N5 in Japanese Language Proficiency Test or equivalent.

(3) Japanese Intensive Track B (CLER):

This track is designed for Chinese character users and Asian students. For more information please refer to the following website.

Admission URL:
<https://www.sophia.ac.jp/eng/admissions/>

SUMMER SESSIONS & JANUARY SESSION

Summer Session in East Asian Studies and Japanese Language

This program consists of Summer Session 1 (four weeks in June) and Summer Session 2 (four weeks in July). It provides participants with opportunities to take part in an East Asian studies program and an intensive Japanese language program in both sessions.

1) East Asian Studies Program

This program provides students with the opportunity to study abroad in Japan and explore the country's relation with Asia and the rest of the world. Students choose two or three intensive courses (two credits each) from a list including art, history, religion, literature, business and economics. Field trips and special events are included, such as opportunities to experience a Japanese tea ceremony and visit Meiji Shrine.

*Cultural activities and field trips are subject to change

2) Japanese Language Program

This program is tailored for students who want to intensively improve their Japanese Language abilities in Japan. Students will take a Japanese Language course (two credits) at the beginner, intermediate, advanced intermediate, or advanced level in an international environment. Class size is small, with around 20 students. In addition to the intensive Japanese Language course, the Japanese Language and Culture course will be offered (two credits).

To further enhance the effectiveness of Japanese language acquisition, students will have opportunities to practice their language skills with native Japanese students through Cultural workshops, which are related to Japanese Culture. Furthermore, events with Sophia students will be offered.

January Session in Japanese Studies

(Four weeks in January)

This program has been designed mainly for international students who can come to Japan in January. The program consists of five courses on "Japanese Business and Economy", "Media and Contemporary Issues in Japan", "Education in Japan", "Contemporary Japanese Culture and Society", (two credits each) and Japanese language (one credit). Among those courses, students can take two or three courses. Fields trips and events with Sophia students are also offered in the program.*



Admission URL:
<https://www.sophia.ac.jp/eng/admissions/summer>



Seasons on Campus



4 **Entrance Ceremony**
The entrance ceremony marks the start of each new student's life at Sophia University.

7 **Jochi-Nanzan Sports Festival**
The sports competition, a long-running tradition between Sophia and Nanzan Universities. Each year it provides an opportunity for intense intercollegiate rivalry and exchange.

10 **Music Festival**
Sophia's Music Festival takes the form of a joint concert at which the Music Council's member groups showcase the fruits of the last year of practice.

12 **Christmas Event**
A Christmas mass is held in the No. 10 Building's auditorium as the illuminated campus is enveloped in solemn quiet.

4 **Beginning of Spring Semester**
After the entrance ceremony, new students, faculty members, and senior students get to know each other at orientation camps held by each faculty. Freshman Week, which offers opportunities to get involved in a variety of group and club activities, awaits when they return from camp.

9 **Beginning of Autumn Semester**
Most of the English-taught programs accept students from Autumn Semester as well as Spring Semester. There is an entrance ceremony for new students.

11 **Sophia Festival**
The Sophia Festival offers an extensive selection of stage performances and snack booths. All visitors are welcome to join in the fun!

3 **Graduation Ceremony**
(March or September)
It's finally time for students to begin their journey as graduates. The University celebrates their new life and the promise of the future.

- APRIL** · Spring Semester Starts
- Entrance Ceremony for spring admission students
- Guidance for new students
- Orientation camp for new students
- Course registration
- Classes start

MAY · All Sophians' Festival (Home Coming Day)

JULY · Jochi-Nanzan Sports Festival

- JULY** · Final examinations
- Classes end

AUGUST · Summer recess

- SEPTEMBER** · Autumn Semester Starts
- Entrance Ceremony for autumn admission students
- Graduation ceremony
- Guidance for new students
- Orientation camp for new students
- Course registration
- Classes start

- OCTOBER** · Music Festival

- NOVEMBER** · Foundation day
- Sophia Festival

- DECEMBER** · St. Xavier's day
- Christmas Event
- Winter recess

- JANUARY** · Final examinations
- Classes end

FEBRUARY · Spring recess

MARCH · Graduation Ceremony

Campus Map Sophia Yotsuya Campus



A view of Bldg. 2 from Sanadabori field

2 Building 2

This tower houses research and education facilities in its 17 above ground and 3 basement floors. It also home to administrative offices tasked with helping students, a state-of-the-art-computer lab, computer-assisted language learning (CALL) room for use in foreign-language education, TV center equipped to a commercial broadcast station standard, cafeteria, bookstore, and other facilities.



A view of Bldg. 6 from Kojimachi-Odori

6 Building 6 / Sophia Tower

A new symbolic tower building of the university with 17 floors, a part of which is offered as a rental office space. On the 1st floor, there is an exhibition space with displays to introduce history and culture of Sophia and its neighborhood. Floor 1st to 6th houses an 800-seat hall, fully-equipped classrooms, the Language Learning Commons, the Center for Language Education and Research that manages language education for all the Sophia students.



Central Library

15 Central Library

This library holds approximately 1,100,000 books and 11,000 periodical titles in 9 above ground and 2 basement floors. An open stack system gives users direct access to materials. It also accommodates various research institutes on the 4th to 8th floors, making it a center of research activities.



Kulturheim in Autumn

23 Kulturheim

The oldest building on campus, it stood before the founding of the University. Today it is a Jesuit church, a place for prayer and worship.

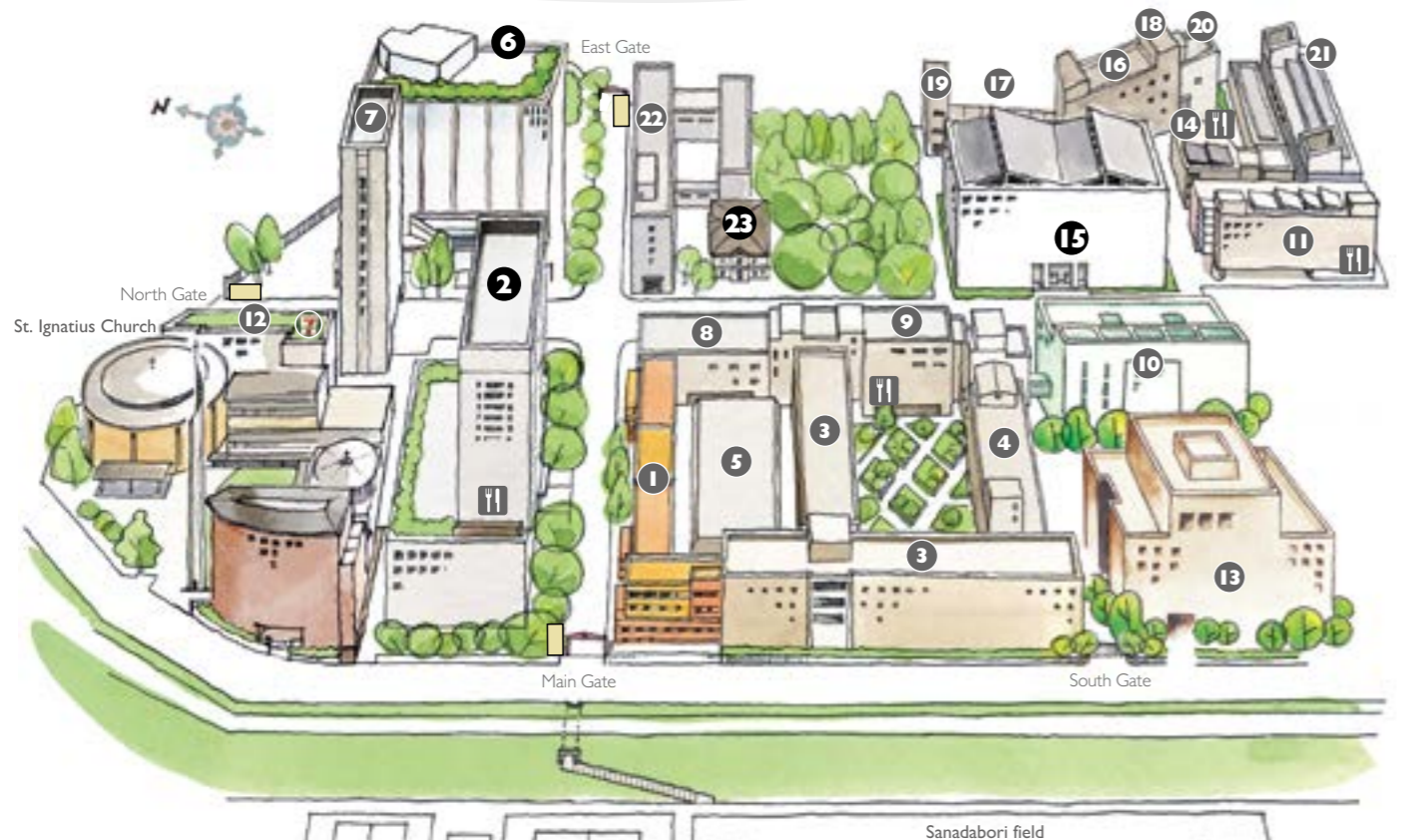

- 1 Building 1 2 Building 2 3 Building 3 4 Building 4 5 Gymnasium 6 Building 6 / Sophia Tower 7 Building 7 8 Building 8
- 9 Building 9 10 Building 10 / Auditorium 11 Building 11 12 Building 12 13 Building 13 14 Hoffmann Hall 15 Central Library 16 Krupp Hall
- 17 Machine Hall 18 Power Station I 19 Power Station II 20 Power Station III 21 Jochi Kioi Building 22 SJ House 23 Kulturheim 11 Cafeteria

Distinguished Visitors to Sophia Yotsuya Campus

Thanks to Sophia University's strong links to the Catholic Church and to various countries' embassies, many distinguished visitors have come to its campus to give lectures and interact with students. The list of distinguished guests includes:

- Helmut Kohl (Chancellor of West Germany) / 1983
- Lech Walesa (President of Poland) / 1994
- Morihiro Hosokawa (Prime Minister of Japan. Alumnus of Sophia) / 1994
- José María Aznar Lopez (Prime Minister of Spain) / 1997
- Andrés Pastrana (President of Republic of Colombia) / 1999
- Gerhard Fritz Kurt Schröder (Chancellor of Germany) / 2004

- Robert Michael Gates (U.S. Secretary of Defense) / 2007
- Jean-Claude Juncker (Prime Minister of Luxemburg) / 2010
- Benigno S. Aquino III (President of the Republic of the Philippines) / 2013
- Thomas Yayi Boni (President of the Republic of Benin) / 2013
- Richard L. Armitage (Former U.S. Deputy Secretary of State) / 2014
- Emanuel Manny Mori (President, the Federated States of Micronesia) / 2014
- Tabaré Vázquez (President of the Oriental Republic of Uruguay) / 2015
- Caroline Kennedy (U.S. Ambassador to Japan) / 2016



Pope John Paul II / 1981 Mother Teresa / 1981, 82, 84 Laureate, Nobel Peace Prize Condoleezza Rice / 2005 U.S. Secretary of State Wen Jiabao / 2011 Premier, People's Republic of China António Guterres / 2017 UN Secretary-General Pope Francis / 2017 *Through video conference